

Armidale PLace

MONTPELIER

APPROXIMATE FLOOR AREA
59 SQM / 635 SQFT

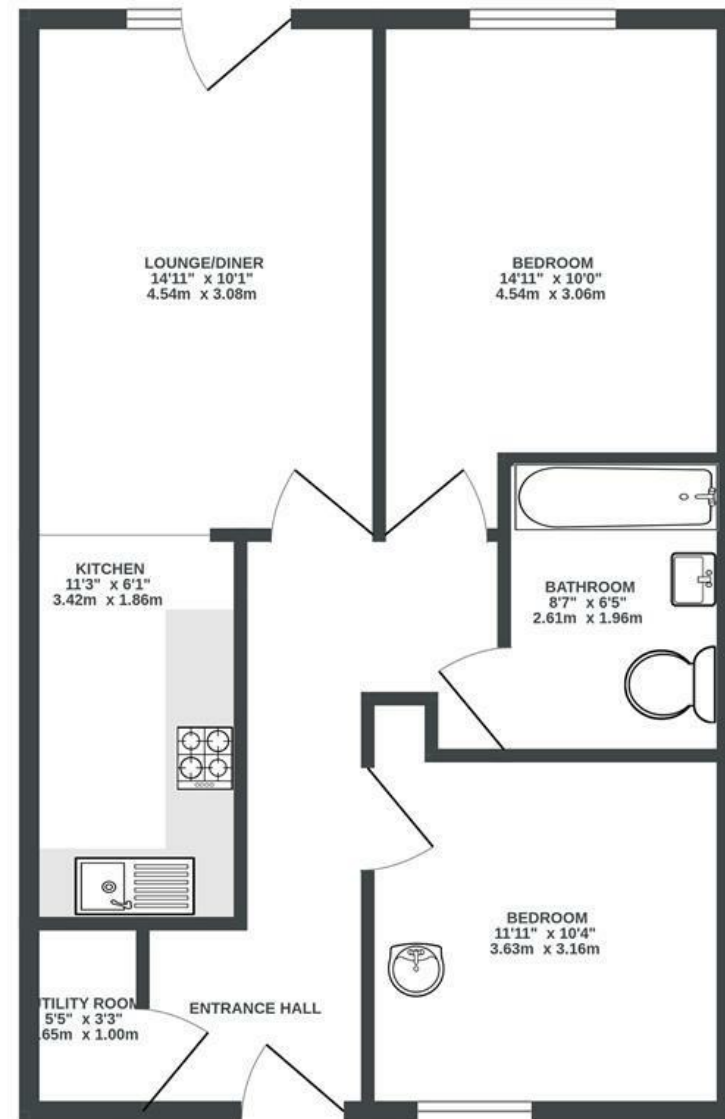

FIRST FLOOR

Boardwalk

Armidale Place

, BRISTOL

£

£250,000

zzz

2 Bedrooms



BS6 5BQ



1 Bathrooms

"Armidale Place has the perfect mix of both stimulation and tranquility. Montpelier is a fantastic location, just a 10 minute walk from the town centre, or stay local in the Gloucester Road with its multiple eateries, independent shops and live music venues. St Andrews Park and St Werburghs City Farm provide local green spaces or head off by train or car to surrounding countryside."

